

Rotation Stages

- Five-phase stepper motor
- 360 degree continuous motion
- Positional repeatability to ≤ 0.02 degrees
- Low, compact profile
- Dual axis for independent rotation around a common axis.
- Adapters available to hold a variety of optical components.

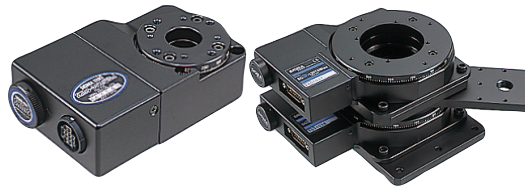

- Piezo Stages
- Linear Stages
- Rotation Stages
- ZF Stages
- Motorized Optics Holders
- Goniometers
- GS Closed Loop Stages
- Controllers & Drivers
- Cables & Accessories
- Software

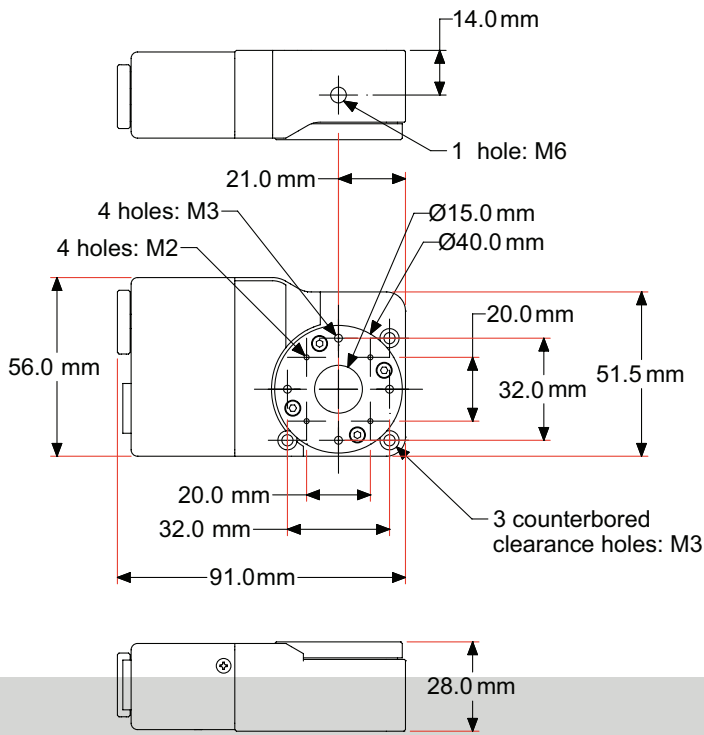

SGSP-40 YAW ROTATIONAL MOTOR STAGE

Specifications & Tolerances

Dimensions:
 ± 0.2 mm
 Max travel speed:
 30 degrees/sec
 Positional Repeatability:
 ≤ 0.02 degrees
 Position accuracy:
 ≤ 0.06 degrees
 Backlash:
 ≤ 0.05 degrees
 Wobble:
 ≤ 0.02 mm

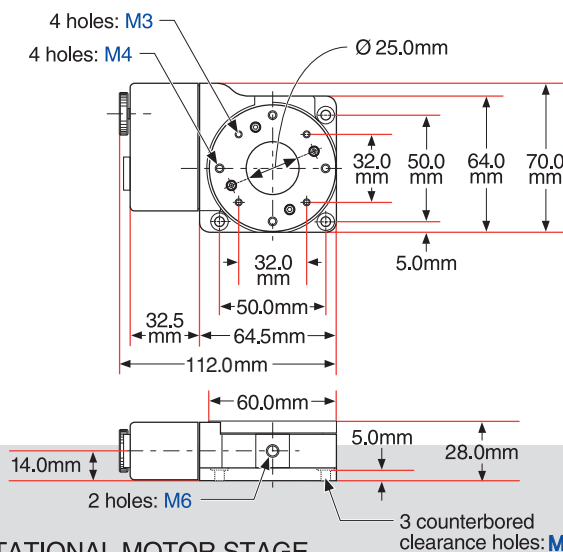

SGSP-60 YAW ROTATIONAL MOTOR STAGE

ORDERING
 &
 TECHNICAL SUPPORT
 (949) 851-5881
 FAX (949) 851-5058
 E-MAIL
sales@optosigma.com
 WEB
www.optosigma.com



MOTOR STAGES

Piezo Stages

Linear Stages

Rotation Stages

ZF Stages

Motorized Optics Holders

Goniometers

GS Closed Loop Stages

Controllers & Drivers

Cables & Accessories

Software

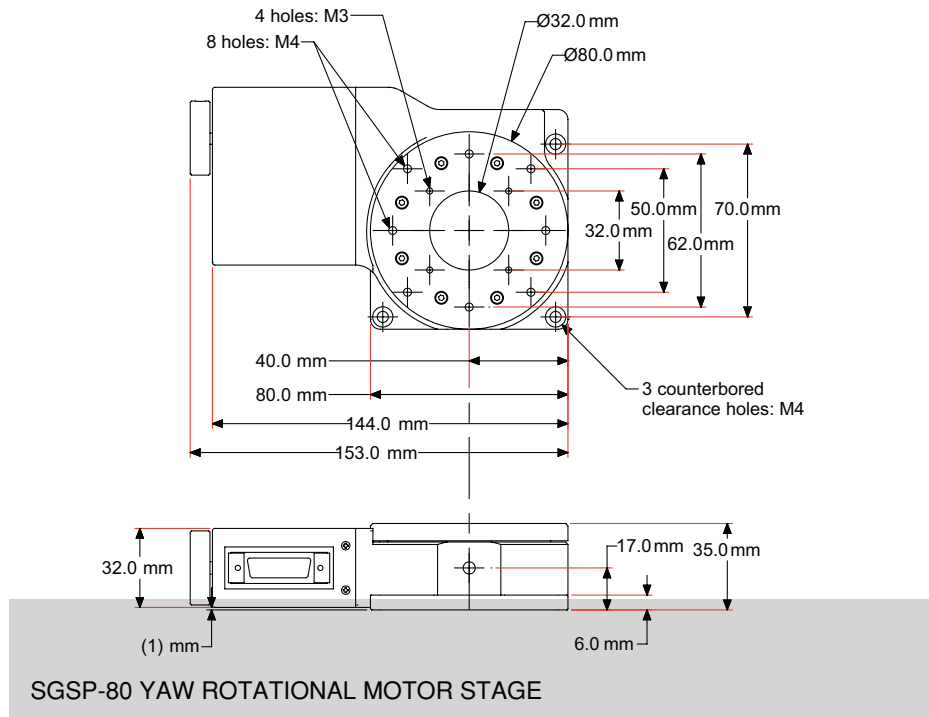

Part No. — Dimensions (mm) —

| | A | B |
|-------------|------|-------|
| SGSP-120YAW | 64.5 | 120.0 |
| SGSP-160YAW | 60.0 | 160.0 |

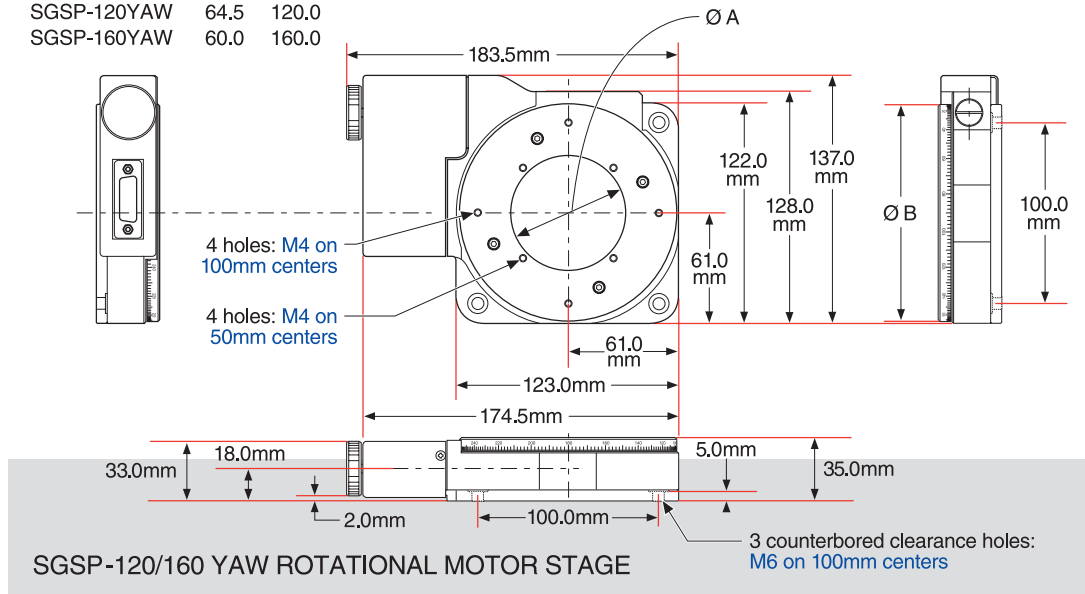

Rotation Stages

| Table Size | Axis | Load Capacity | Weight (kg) | Price | Model | PART NUMBER |
|------------|------|---------------|-------------|-------|--------------------|-------------|
| 40mm | 1 | 2kg | 0.35 | | SGSP-40YAW(Øz) | 513-4010 |
| 60mm | 1 | 3kg | 0.45 | | SGSP-60YAW(Øz) | 513-6010 |
| 60mm | 2 | 3kg | 1.00 | | SGSP-60YAW(Øz)-AØ | 513-6010-2 |
| 80mm | 1 | 10kg | 1.10 | | SGSP-80YAW(Øz) | 513-8010 |
| 120mm | 1 | 20kg | 2.00 | | SGSP-120YAW(Øz) | 513-1210 |
| 120mm | 2 | 20kg | 5.50 | | SGSP-120YAW(Øz)-AØ | 513-1210-2 |
| 160mm | 1 | 20kg | 2.50 | | SGSP-160YAW(Øz) | 513-1610 |

KST Precision Motorized Rotation Stages

- High load capacity
- High stiffness
- Angular repeatability less than 0.01°
- 5-phase stepper motor for easy setup and compatibility with our SHOT-200 and SHOT300 series controllers.



Piezo Stages

Linear Stages

Rotation Stages

ZF Stages

Motorized Optics Holders

Goniometers

GS Closed Loop Stages

Controllers & Drivers

Cables & Accessories

Software

Part No. 513-2120

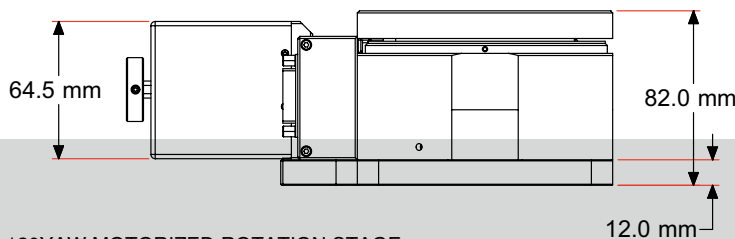
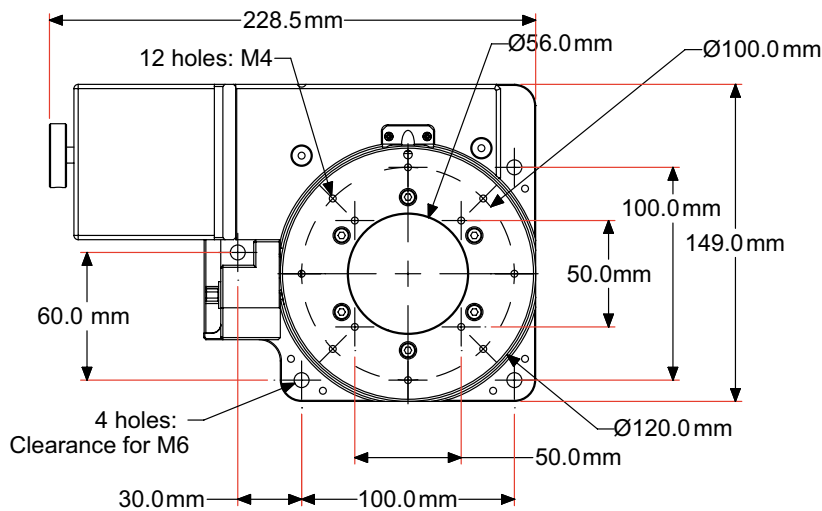

KST-120YAW MOTORIZED ROTATION STAGE

ORDERING
&
TECHNICAL SUPPORT
(949) 851-5881
FAX (949) 851-5058
E-MAIL
sales@optosigma.com
WEB
www.optosigma.com



Part No. 513-2120

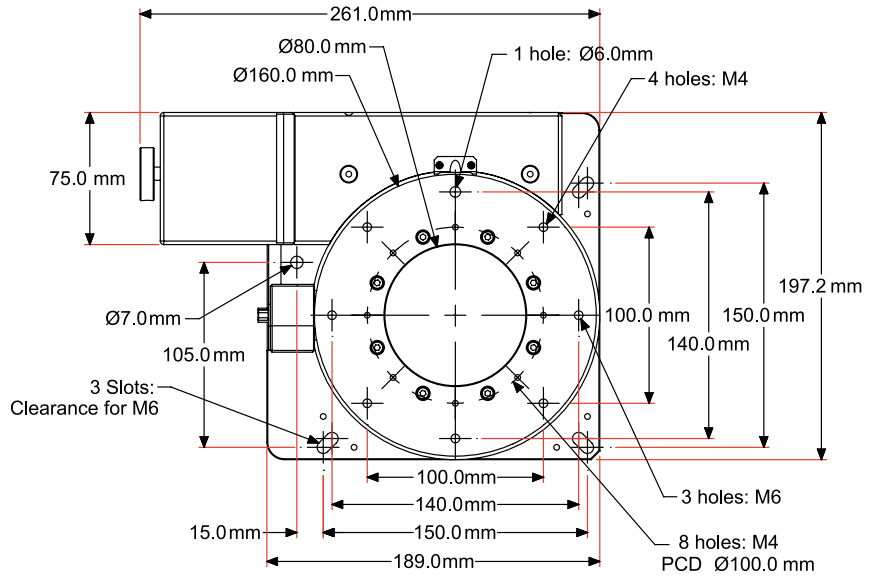

KST-160YAW MOTORIZED ROTATION STAGE

Specifications & Tolerances

| | |
|---------------------------|----------------|
| Dimensions: | ±0.2mm |
| Max travel speed: | 30 degrees/sec |
| Positional Repeatability: | <0.01 degrees |
| Position accuracy: | <0.06 degrees |
| Backlash: | <0.01 degrees |
| Wobble: | <0.01mm |

KST Precision Motorized Rotation Stages

| Table Size | Axis | Load Capacity (kg) | Weight (kg) | Price | Model Number | PART NUMBER |
|------------|------|--------------------|-------------|-------|--------------|-------------|
|------------|------|--------------------|-------------|-------|--------------|-------------|

| | | | | | | |
|-------|---|----|-----|-------------|------------|----------|
| 120mm | 1 | 35 | 5 | \$ 4,500.00 | KST-120YAW | 513-2120 |
| 160mm | 1 | 40 | 8.5 | \$ 5,000.00 | KST-160YAW | 513-2160 |

ORDERING & TECHNICAL SUPPORT
 (949) 851-5881
 FAX (949) 851-5058
 E-MAIL sales@optosigma.com
 WEB www.optosigma.com

